

## Wall Outlet H2 UK USER Manual

Product Introduction

The Aqara Wall Outlet H2 UK is a smart wall outlet based on the Thread/Zigbee wireless communication protocol, designed for double-gang UK wall boxes. It features dual channels power monitoring, USB-C fast charging ports, and multi-function control via the button with red/blue LED indicators (single press, double press, long press). With built-in scheduling, power-off memory, child lock, overload and overheat protection, it enables intelligent energy management and seamless integration into smart home ecosystems when paired with a compatible hub.

\*To use the device with a particular Matter ecosystem, a Matter Controller of said ecosystem and a Thread Border Router are required. In most cases, a Thread Border Router is integrated in your Matter Controller, combining both functions in one device.

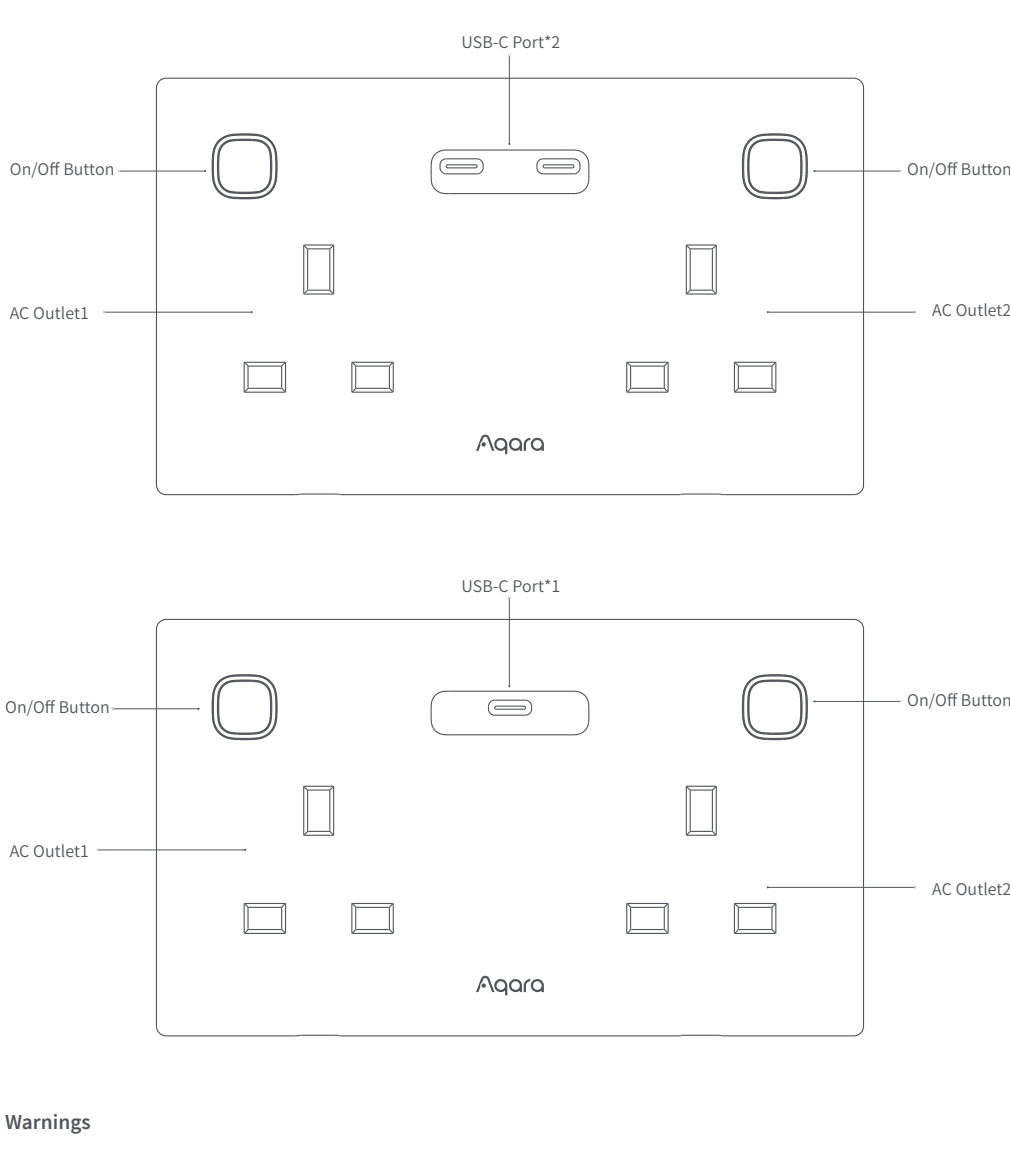

Warnings

- 1. This product is not a toy. Please keep children away from this product.
- 2. This product is designed for indoor use only.
- 3. Do not use in humid environments or outdoors.
- 4. Beware of moisture. Do not spill water or other liquids onto the product.
- 5. Do not place this product near a heat source. Do not place it in an enclosed space unless there is normal ventilation. Do not attempt to repair this product by yourself. All repairs should be performed by an authorized professional.
- 6. This product is designed to enhance your home experience and keep you informed about device status. If a user violates the product use instructions, the manufacturer will not be liable for any damage and/or property losses.

Installation Method

The installation involves electrical wiring. For safety reasons, we recommend that this operation be performed by a professional electrician.

- 1 Please make sure that the power at the circuit breaker or fuse box is turned off before you begin wiring!

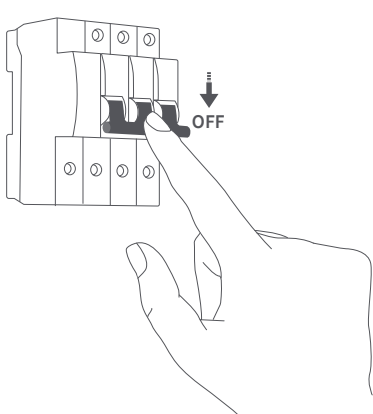

- 2 Disassemble the outlet into:

- (1) Cover plate
- (2)Outlet module
- (3)10mm spacer (optional)
- (4)Screws kit

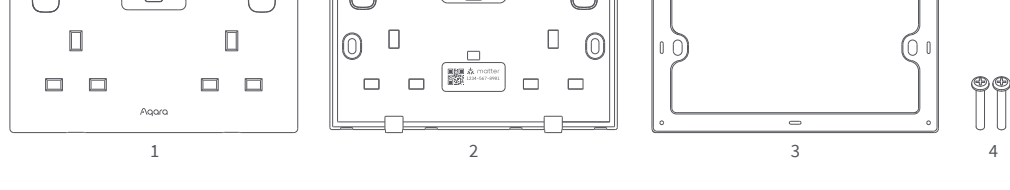

- 3 When installing the outlet, first check the depth of the back box. If the back box depth is only 25mm, you will need to use our accessory: a 10mm spacer. If the back box depth is greater than 35mm, no accessory is required, and you can proceed with the wiring directly.

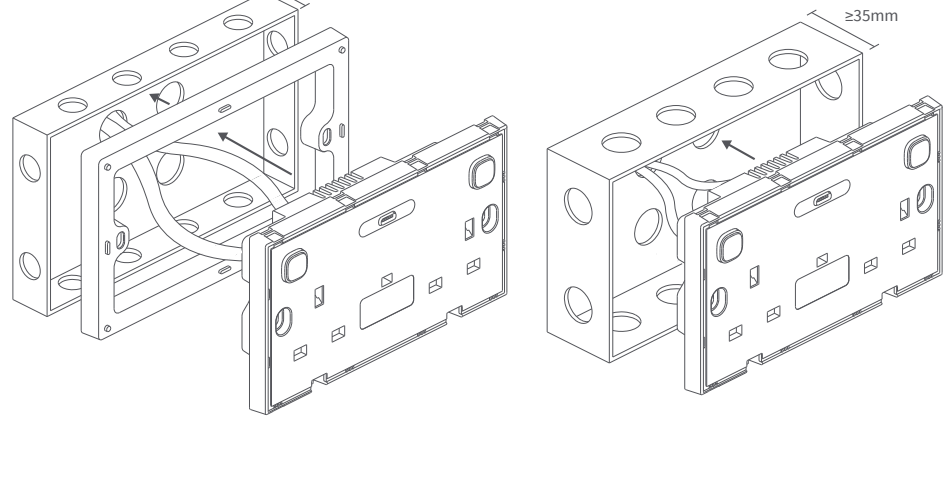

- 4 Use a screwdriver to loosen the terminal screws. Connect the live wire to the L terminal, the neutral wire to the N terminal, and the earth wire to the Earth terminal. After confirming the wiring is correct, tighten the terminal screws securely.

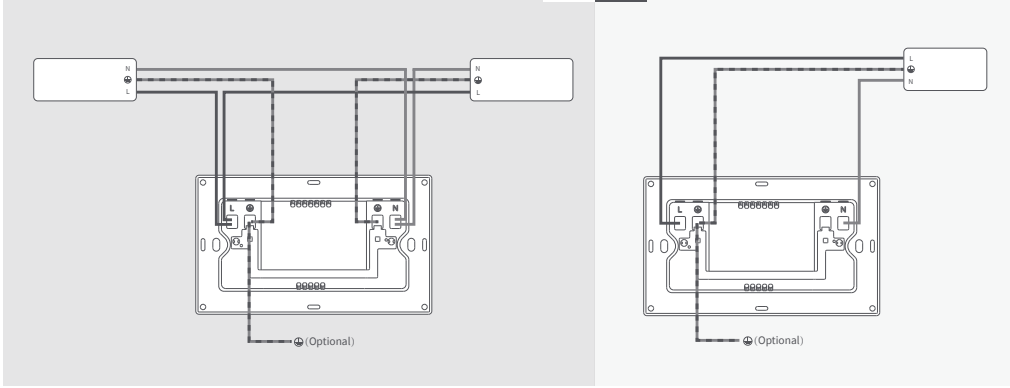

- 5 Mount the outlet unit to the wall back box with the attached screws.

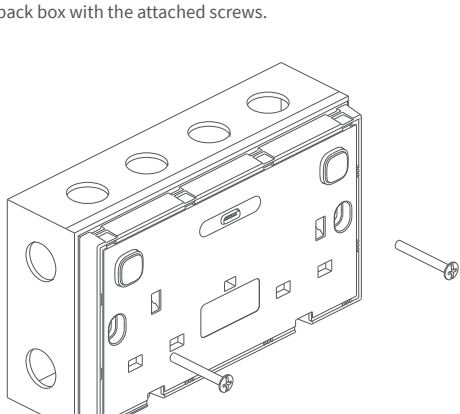

- 6 Mount the cover plate with the outlet module.

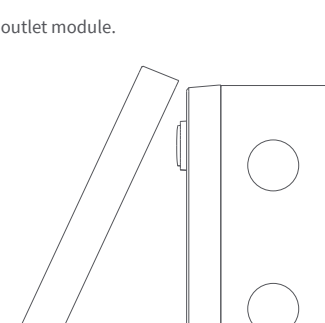

- 6 Turn on main power at the circuit breaker and test the outlet by pressing the On/Off button.

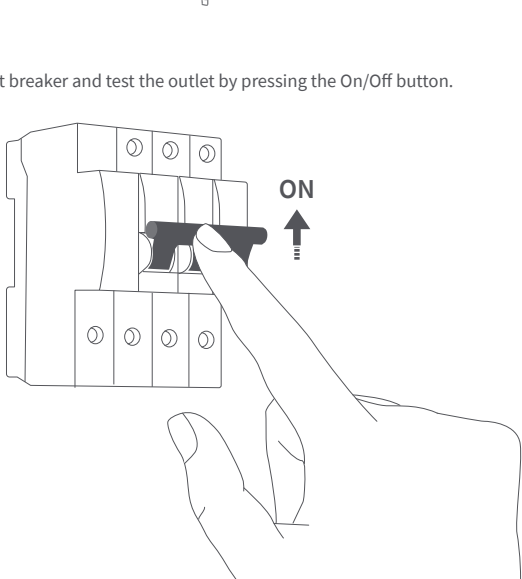

Quick Setup

To use the device with a particular Matter ecosystem (Thread Mode), a Matter Controller of said ecosystem and a Thread Border Router are required.

- (1)Double-press any button, then press and hold it for 5 seconds until the blue indicator light starts blinking. This indicates that the device is in pairing mode.
- (2)Open the app that supports Matter, scan the Matter code on the manual or product, or enter the setup code to add the device to the app.
- (3)Proceed following the app's instruction.

To use the device in Aqara Home (Thread Mode), an Aqara Hub with border router function (for example, Hub M3) is required:

- (1)Double-press any button, then press and hold it for 5 seconds until the blue indicator light starts blinking. This indicates that the device is in pairing mode.
- (2)In the Aqara Home app, tap Add Accessory, choose Wall Outlet H2 UK. Scan the Matter code on the manual or product or enter the setup code to add the device to the app. Select Thread under Switch Protocol page.
- (3)Proceed following the app's instruction

To use the device in Aqara Home (Zigbee Mode), an Aqara Zigbee Hub is required:

- (1)Double-press any button, then press and hold it for 5 seconds until the purple indicator light starts blinking. This indicates that the device is in pairing mode.
- (2)In the Aqara Home app, tap Add Accessory, keep the phone close to the device, and Wall Outlet H2 UK will show in the app's discovery section (at the top left). Tap the icon and select Zigbee under Switch Protocol page.
- (3)Proceed following the app's instruction.

Button Operations

Button		Operation	Function
Common Operation	ON/OFF button	Press 3 times	Locate device
		Double- press, then press and hold for 5 s (within 3 s)	Reset device and enable pairing
		Press 10 times in a row	Restore factory settings and enable pairing
		Single press	Relay on and off control
Zigbee Multi-Function Mode	ON/OFF button	Single press	Relay on and off control
		Double press	Trigger automation action
		Long press	Trigger automation action

Indicator Light Description

Indicator light status	Description
Blue indicator light flashes 1 time	Device powered on
Blue indicator light flashes quickly	Pairing in progress/ finding device (Thread protocol)
Blue indicator light stays on for 1s	Pairing successful
The blue indicator light stays on	Load Power-On
Red indicator light stays on	Device offline/Overheat or Overload Protection
Red indicator light flashes slowly 3 times	Paring failed
Purple indicator light flashes slowly 3 times	Child lock mode
Purple indicator light flashes quickly	Pairing in progress/ finding device (Zigbee protocol)

Product Specifications

Product Name	Wall Outlet H2 UK (Single USB-C)	Wall Outlet H2 UK (Dual USB-C)
Model	WP-P09E	WP-P09D
Number of USB ports	1	2
USB-C Output	USB-C Output (Single Port): 5.0V~3.0A, 15.0W / 9.0V~2.22A, 20.0W / 12.0V~1.67A, 20.0W	USB-C Output (Single Port): 5.0V~3.0A, 15.0W / 9.0V~3.0A, 27.0W / 12.0V~2.5A, 30.0W / 15.0V~2.0A, 30.0W / 20.0V~1.5A, 30.0W USB-C Output (Dual Port): 5.0V~3.0A (shared), 15.0W (total)
Wireless Protocols	Thread, Bluetooth, Zigbee	
Dimensions	146mm x 86mm x 38.4mm	
Electrical Rating	230-250 VAC, 50/60 Hz, Max 13 A, μ	
Thread Operation Frequency	2405 – 2480 MHz	
Thread Maximum Output Power	≤ 8 dBm	
Zigbee Operation Frequency	2405 – 2480 MHz	
Zigbee Maximum Output Power	≤ 8 dBm	
Bluetooth Operation Frequency	2402 - 2480 MHz	
Bluetooth Maximum Output Power	≤ 8 dBm	
Operating Temperature	-5°C ~ 40°C	
Operating Humidity	0 ~ 95% RH, no condensation	